

# AMENDMENT 1 - ISSUED NOVEMBER 5, 2021

TO THE

GRASS VALLEY SCHOOL DISTRICT

REQUEST FOR PROPOSAL

FOR

Wireless Local Area Network to be  
Funded by E-Rate Year 25 (2022-2023)

Released October 25, 2021

The purpose of this Amendment is to address/provide the following:

- Correction of language in Section 1 of the RFP
  - Paragraph 3 is corrected to: Grass Valley School District, herein after referred to as the District, intends to secure a contract for Wireless Local Network Equipment as defined in Section 3.
  - Paragraph 5 is corrected to: In order for proposals to be valid it must address all aspects of desired Local Area Equipment Refresh and be received by the District's representative no later than 5:00pm, Friday, December 17, 2021.
  
- Correction of language in Section 3.2 of the RFP
  - Section 3.2 Item 1 is corrected to: The District has identified the need to upgrade Wireless Local Area Network Equipment at all District locations to improve network performance through replacement of existing Ruckus Wireless Equipment.
  - Section 3.2 Item 2 is corrected to: The District has identified additional need to extend Local Area Network at Grass Valley Charter School to remote Gardening Office and Maintenance Building through addition of Point to Point Wireless Ethernet Bridge.
  
- Correction of language in Section 3.3 of the RFP
  - Local Area Network Extension Point to Point Requirement - Bullet 3 is corrected to: Licensing Costs, if applicable.
  -
  
- Modify Section 5 RFP Terms to extend the date of response submission.
  - Section 5 is hereby modified to: District requires RFP submittals no later than 5:00pm, Friday, December 17, 2021. Proposals must be valid through the E-Rate Funding Year 2022-2023.

- Modify Section 7 Contact Information to extend the last date for submission of questions from potential vendors.
  - Section 7 hereby modified to: Last date to submit questions, November 19, 2021.
  
- Provide responses to questions raised by potential vendors as of November 3, 2021, as follows:
  - Are there plans to upgrade the Wired portion? I only ask because It might be the best time to switch and have both wired and wireless under one command portal.
    - Response - No
  - Does Grass Valley DS have VMware/HyperV?
    - Response - VMware
  - How many APs do you have in the District today?
    - 150
  - Could you share the number of rooms that are gyms, libraries and multi-purpose rooms along with how many APs per room estimated that will be more than 1?
    - Response - See attached floor plans.
  - How many clients/AP in classrooms?
    - 20-30
  - How many clients do you want to support in gyms?
    - 100
  - How many clients do you want to support in libraries?
    - 100
  - How many clients do you want to support in multi-purpose rooms?
    - 120
  - Could you send us floor plans and indicated the main internal wall types?
    - Response - See attached floor plan.
  - How many indoor AP are intended for wall mount, beyond the note for ceiling brackets?
    - 0
  - Are the outdoor APs going to be wall mounted?
    - Yes
  - Do you have a high number of 2.4 GHz-only devices at this time, or are you mostly transitioned to devices that are 5 GHz capable?
    - Response - Most sites are using both 2.4GHz and 5 GHz radios on all WAPs.
  - Are you currently leveraging all of your 2.4 GHz radios at this time or is a igh proportion of them being turned off or underpowered due to interference?
    - Response - Most sited are using both 2.4 GHz and 5GHz radios on all WAPs.
  - How important is it that the cloud mgmt. system (if chosen) itself ha full ISO 27001, ISO 27017 and ISO 27701 and other certifications for security, not just a data center a service is stored in?
    - Response - If ISO security measures come at an additional cost and can be listed as an optional line item, that would help the District take into

account both the value of security as well as the overall costs compared to other bids.

- How important is it that the cloud mgmt. system (if chosen) has a record of 100% uptime in the past 12 months?
  - Response - When considering a cloud management option, the District will want a provider with an uptime in the high 90% range. Due to PSPS days, the District may occasionally function offline as well, for which circumstance the ability for WAPs and controllers to function without cloud access is important.
- Provide floor plans of four District Schools

All other terms and conditions and/or requirements in the RFP remain unchanged. Prospective service providers responding to the RFP shall complete the amendment acknowledgement letter and include the acknowledgement letter in the RFP response. Failure to include the amendment acknowledgement letter in the RFP response may render prospective service provider's RFP non-responsive and may be cause for rejection by the District.

District contact:

Rich Tunheim  
Aarrestad-Gjervik Consulting  
47863 Saddle Club Lane  
Santa Rosa, CA. 95409  
[rich@aagjconsulting.com](mailto:rich@aagjconsulting.com)

P. 707-228-9357  
F. 888-812-8992

Totals:  
Indoor: 16  
Outdoor: 1

CLASSROOM  
E1  
WAP

CLASSROOM  
E2  
WAP

WAP

OFFICE  
G1

STORAGE  
G2

WAP

CLASSROOM  
G3

CUST.  
F1

BOYS  
F2

GIRLS  
F3

WAP

CLASSROOM  
D1

WORK RM.  
D2

WAP

CLASSROOM  
D3

OFFICE  
D7

CLASSROOM  
C1

WAP

CLASSROOM  
C2

WAP

WAP

MPR

WAP

BOY'S TOILET  
A6

STAFF RR  
A11

GIRL'S TOILET  
A13

ELECTRICAL RM  
A9

STORAGE RM  
A14

OFFICE  
A10

CLOSET  
A7

JAN.  
A8

CORRIDOR  
A5

CLOS.  
A12

Library

WAP

KITCHEN STAFF RR  
B7

STAFF RR  
B6

WORK RM  
B5

KINDERGARTEN  
A4

WAP

CLASSROOM  
A2

WAP

Yellow House

WAP

STAFF ROO  
B4

NURSE  
B3

KINDERGARTEN  
A3

WAP

CLASSROOM  
A1

WAP

PRINCIPAL  
B2

OFFICE  
B1

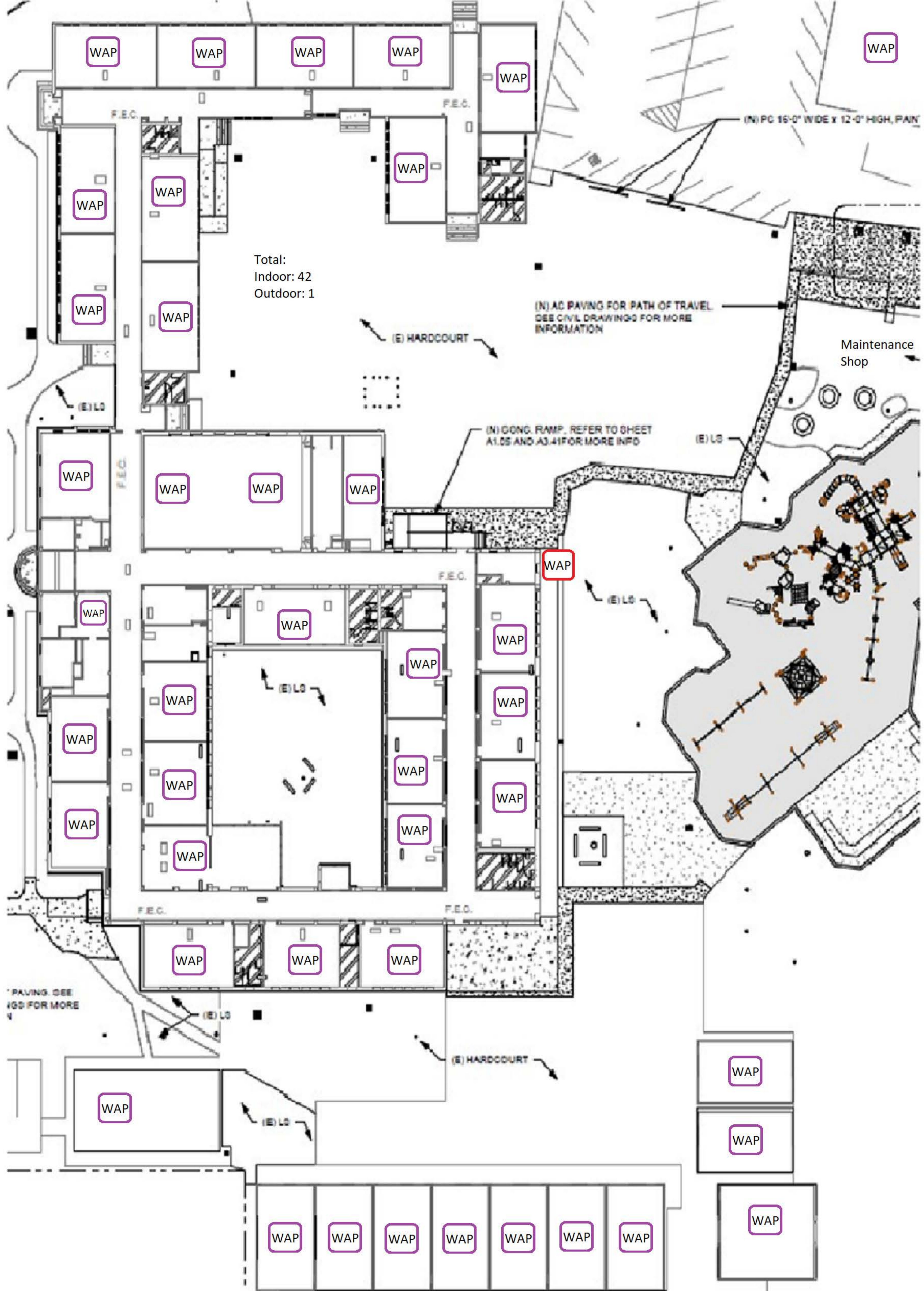

WAP

WAP

WAP

WAP

WAP

WAP

F.E.C.

F.E.C.

(N) PG 16'-0" WIDE X 12'-0" HIGH, PAINT

WAP

WAP

WAP

Total:  
Indoor: 42  
Outdoor: 1

(E) HARD COURT

(N) AD PAVING FOR PATH OF TRAVEL  
SEE CIVIL DRAWINGS FOR MORE  
INFORMATION

Maintenance  
Shop

WAP

WAP

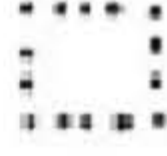

(N) CONC. RAMP. REFER TO SHEET  
A1.05 AND A3.41 FOR MORE INFO

(E) LS

WAP

WAP

WAP

WAP

WAP

F.E.C.

(E) LS

WAP

WAP

WAP

WAP

WAP

WAP

(E) LS

WAP

WAP

WAP

WAP

WAP

WAP

WAP

F.E.C.

F.E.C.

WAP

WAP

WAP

\* PAVING. SEE  
FIGS FOR MORE  
INFO

(E) LS

(E) HARD COURT

WAP

WAP

(E) LS

WAP

WAP

WAP

WAP

WAP

WAP

WAP

WAP

WAP

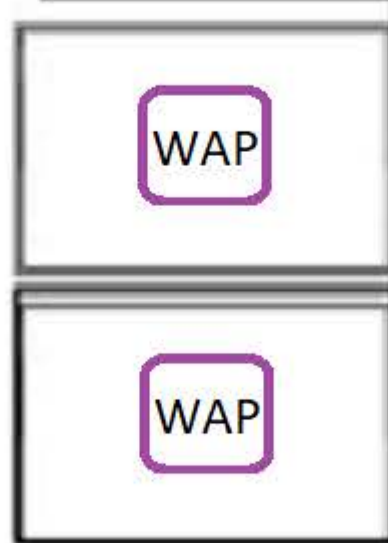

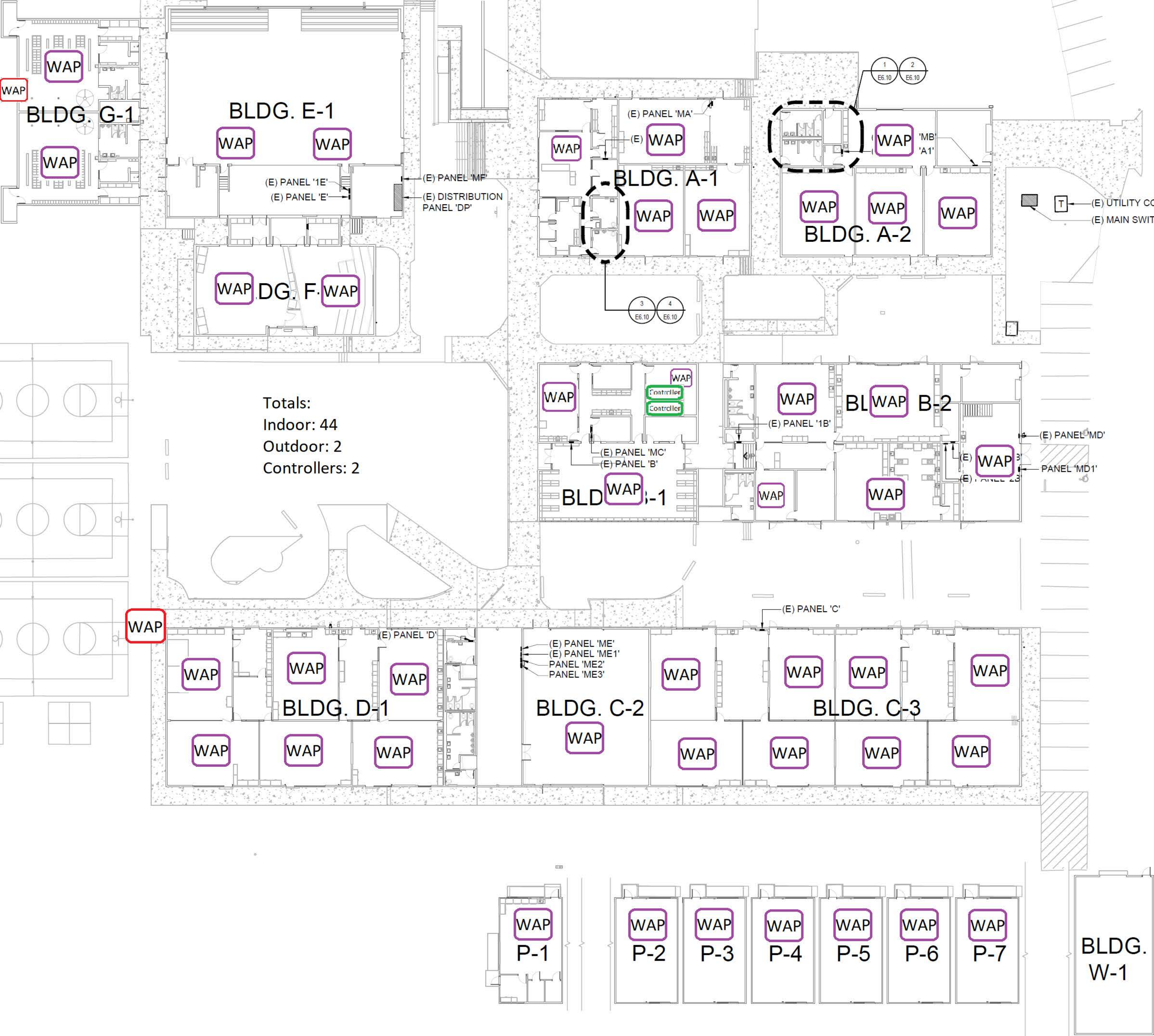

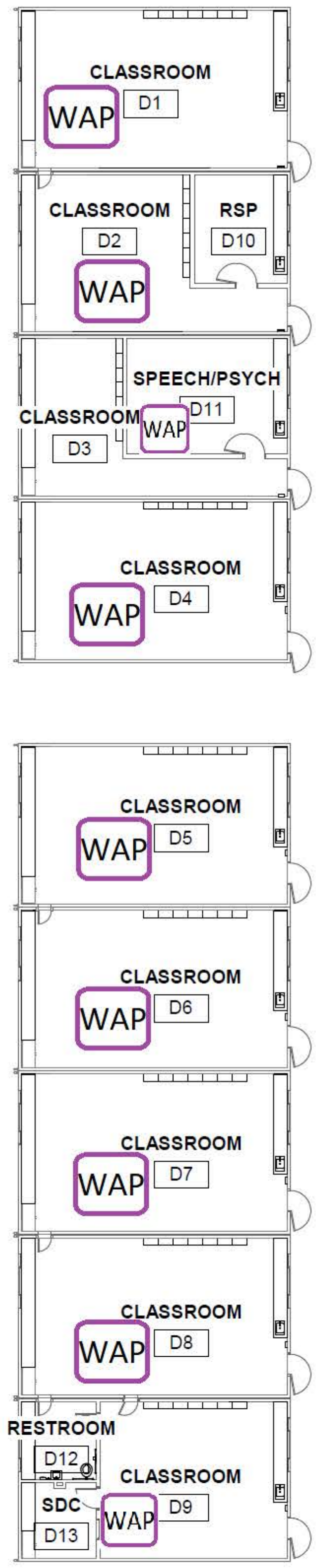

MATCHLINE 1/A3.31  
 MATCHLINE 3/A3.21

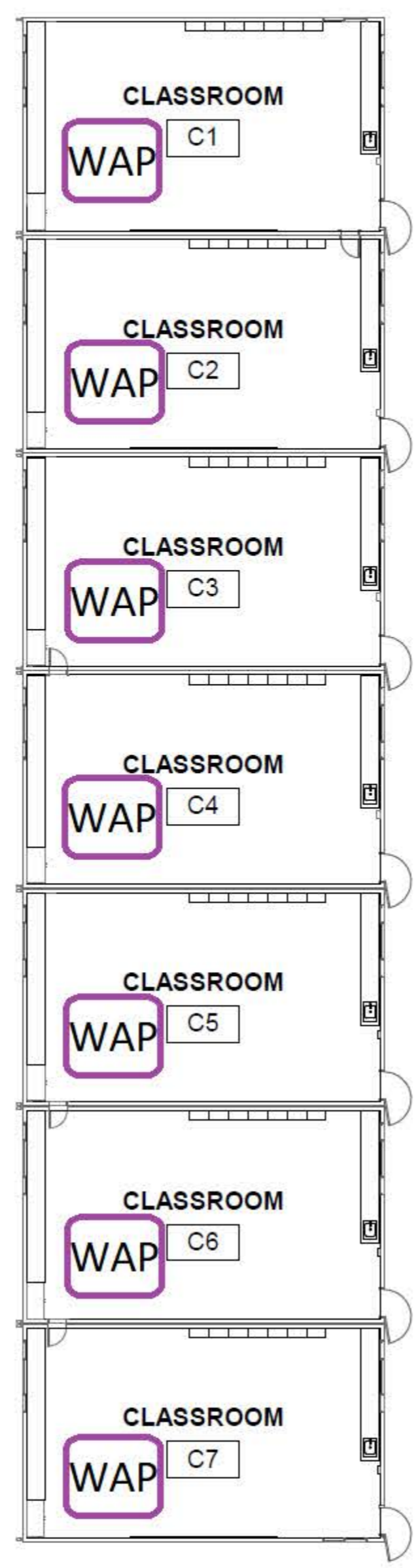

MATCHLINE 1/A3.21  
 MATCHLINE 3/A3.31

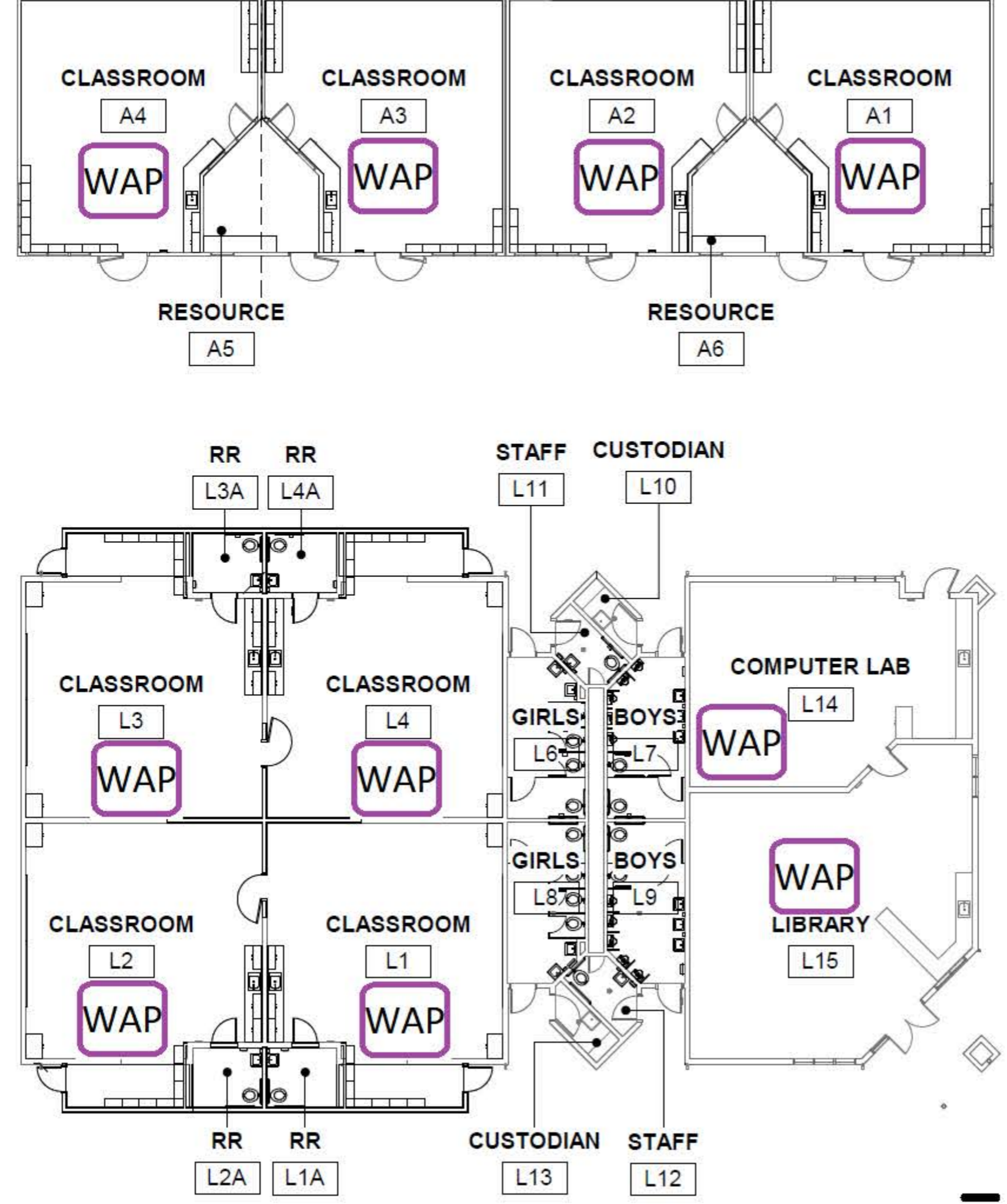

MATCHLINE 1/A3.21  
 MATCHLINE 2/A3.41

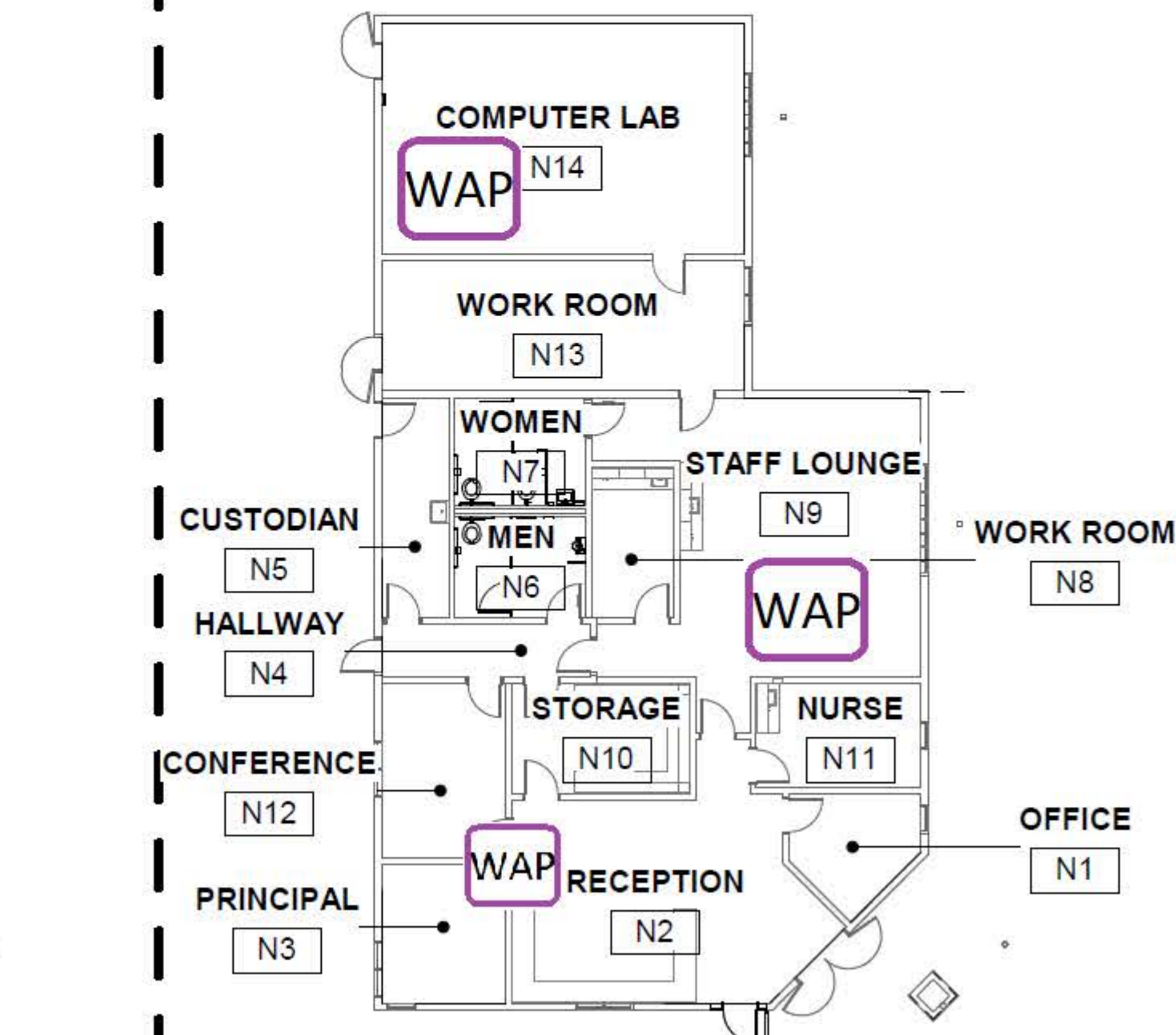

MATCHLINE 2/A3.41

Total:  
 Indoor: 36  
 Outdoor: 1

MATCHLINE 1/A3.41

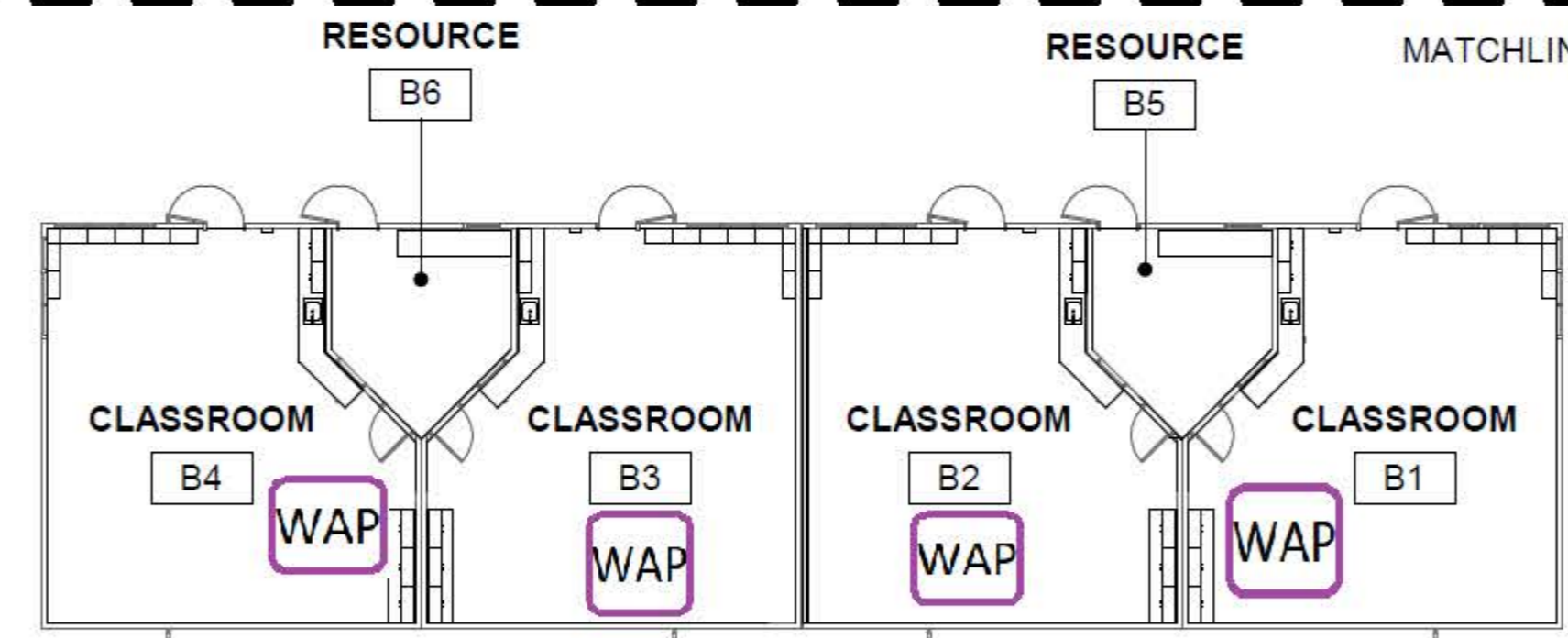

MATCHLINE 2/A3.21

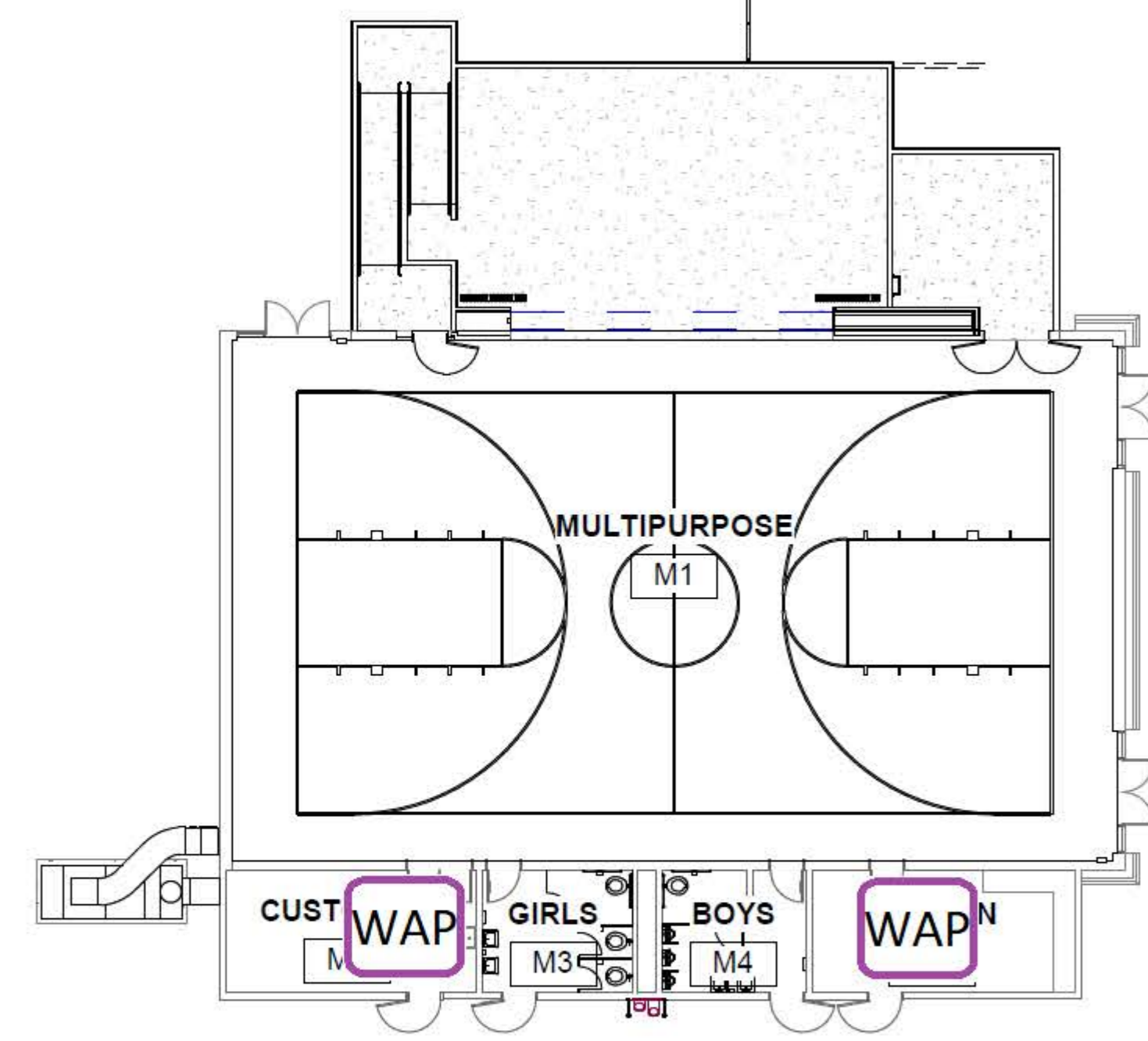

MATCHLINE 1/A3.31

MATCHLINE 2/A3.31

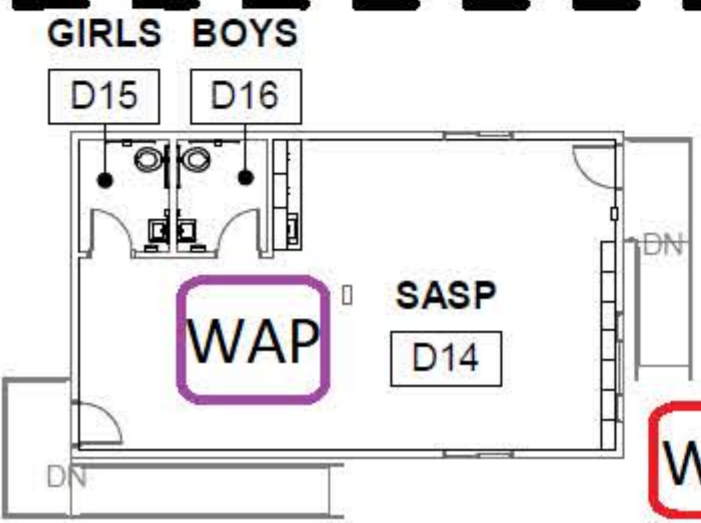

AMENDMENT 1 – ISSUED NOVEMBER 4, 2021

GRASS VALLEY SCHOOL DISTRICT

REQUEST FOR PROPOSAL

FOR

Wireless Local Area Network to be  
Funded by E-Rate Year 25 (2022-2023)

Released October 25, 2021

**ACKNOWLEDGEMENT**

This Amendment Acknowledgement must be signed and included  
in prospective service provider's RFP response.

---

Proposed Service Provider

---

Authorized Signature

---

Name/Title

---

Date



# AMENDMENT 1 - ISSUED NOVEMBER 5, 2021

TO THE

GRASS VALLEY SCHOOL DISTRICT

REQUEST FOR PROPOSAL

FOR

Wireless Local Area Network to be  
Funded by E-Rate Year 25 (2022-2023)

Released October 25, 2021

The purpose of this Amendment is to address/provide the following:

- Correction of language in Section 1 of the RFP
  - Paragraph 3 is corrected to: Grass Valley School District, herein after referred to as the District, intends to secure a contract for Wireless Local Network Equipment as defined in Section 3.
  - Paragraph 5 is corrected to: In order for proposals to be valid it must address all aspects of desired Local Area Equipment Refresh and be received by the District's representative no later than 5:00pm, Friday, December 17, 2021.
  
- Correction of language in Section 3.2 of the RFP
  - Section 3.2 Item 1 is corrected to: The District has identified the need to upgrade Wireless Local Area Network Equipment at all District locations to improve network performance through replacement of existing Ruckus Wireless Equipment.
  - Section 3.2 Item 2 is corrected to: The District has identified additional need to extend Local Area Network at Grass Valley Charter School to remote Gardening Office and Maintenance Building through addition of Point to Point Wireless Ethernet Bridge.
  
- Correction of language in Section 3.3 of the RFP
  - Local Area Network Extension Point to Point Requirement - Bullet 3 is corrected to: Licensing Costs, if applicable.
  -
  
- Modify Section 5 RFP Terms to extend the date of response submission.
  - Section 5 is hereby modified to: District requires RFP submittals no later than 5:00pm, Friday, December 17, 2021. Proposals must be valid through the E-Rate Funding Year 2022-2023.